



[www.myTBI.com](http://www.myTBI.com)

#### Project Quick Facts

##### **Project Scope**

Corridor reconstruction

##### **Project Limits**

State Road 60 from  
I-275 to Veterans  
Expressway

##### **Corridor Length**

3 miles

##### **Contractor**

Flatiron-Tidewater  
Skanska, a Joint Venture

##### **Estimated Construction Cost**

\$212 million

##### **Start Date**

August 15, 2005

##### **Estimated Finish Date**

Spring/Summer 2010

**FDOT Interstate  
Construction Office**  
813-233-3840

**Public/Media Contact**  
John McShaffrey, APR  
813-233-3837

**Web Site/E-Mail**  
[www.myTBI.com](http://www.myTBI.com)  
[info@mytbi.com](mailto:info@mytbi.com)

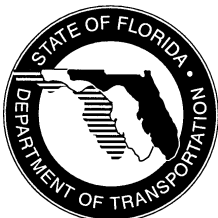

# Road CLOSURE Notice

## Tampa Airport Interchanges

Tampa, Florida

Project Number 255844-1-52-01

May 15, 2008

#### What road will close?

Map on back

**Frontage Road (East)**, which is parallel to the east side of State Road 60/Memorial Highway, *will be temporarily closed* between Spruce Street and Laurel Street.

#### When will Frontage Road close?

Frontage Road (East) will close to traffic between Spruce Street and Laurel Street beginning at approximately 7:00 a.m. on Wednesday, **May 28, 2008**.

#### How long will Frontage Road be closed?

Frontage Road (East), between Spruce and Laurel streets, will be **closed approximately 45 days**.

#### New Access

Map on back

The **new route** for accessing businesses along Frontage Road will be via Laurel Street from O'Brien Street or West Shore Boulevard.

#### For More Info

For information regarding this road closure, please also see the **map on the back** of this notice or contact our project office at (813) 281-9069.

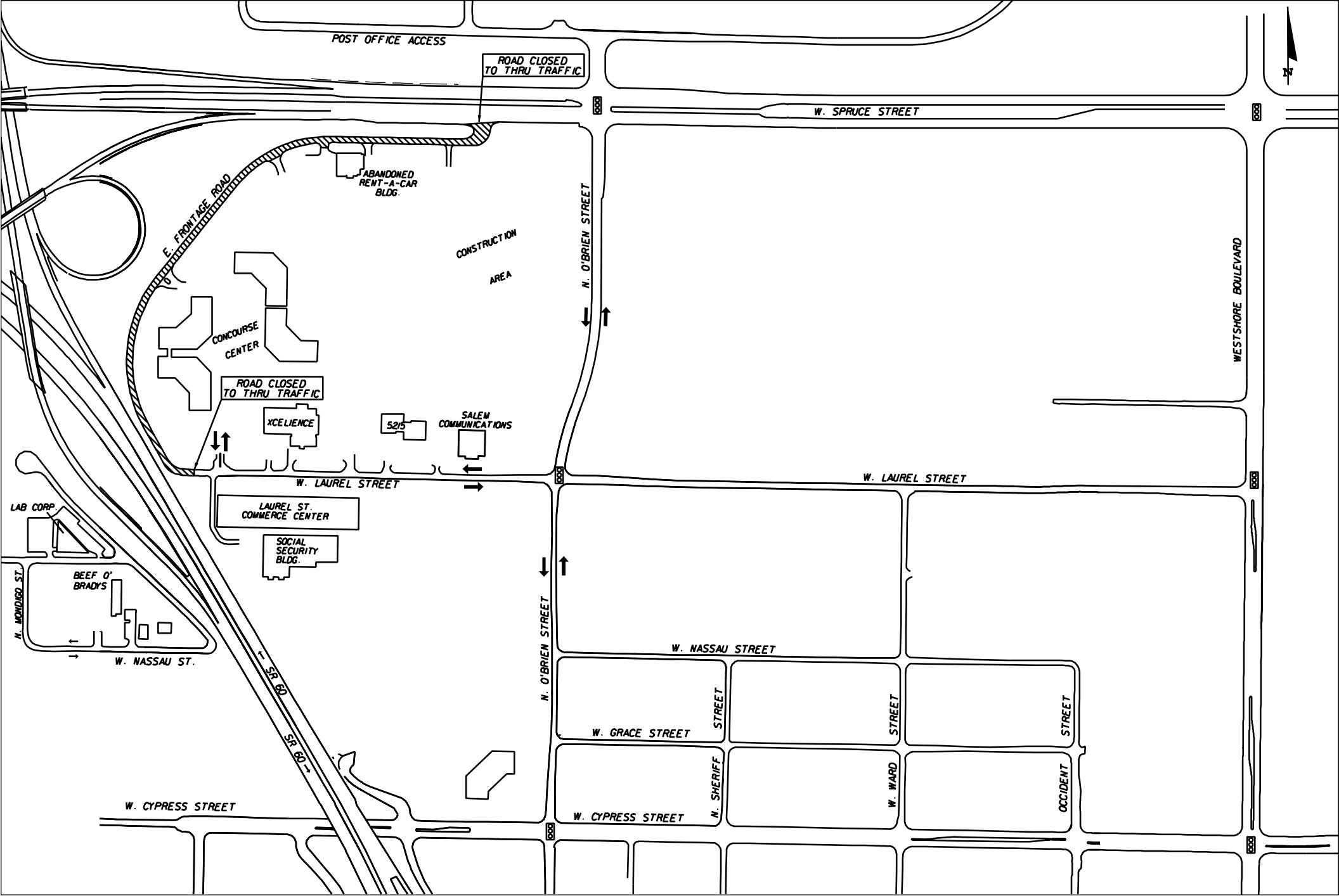

POST OFFICE ACCESS

ROAD CLOSED  
TO THRU TRAFFIC

W. SPRUCE STREET

WESTSHORE BOULEVARD

E. FRONTAGE ROAD

ABANDONED  
RENT-A-CAR  
BLDG.

CONSTRUCTION  
AREA

CONCOURSE  
CENTER

ROAD CLOSED  
TO THRU TRAFFIC

XCELIENCE

5215

SALEM  
COMMUNICATIONS

W. LAUREL STREET

LAUREL ST.  
COMMERCE CENTER

SOCIAL  
SECURITY  
BLDG.

W. LAUREL STREET

W. NASSAU STREET

W. GRACE STREET

W. CYPRESS STREET

W. CYPRESS STREET

BEEF O'  
BRADYS

W. NASSAU ST.

SR 60

SR 60

N. O'BRIEN STREET

N. SHERIFF STREET

N. WARD STREET

OCCIDENT STREET

24